

CASE STUDIES

PRIVATE YACHT

A motor yacht, owned by a client with photophobia, a light sensitivity disorder. JVL Studio has completely redesigned the lighting system of the yacht and also suggested revisions in lighting for the interior. The existing lighting of the boat was seen to be out of balance, full of glare and without any consistency in the color temperature. The control system for the lighting was also inadequate in allowing for human comfort and ease of operation.

For the new lighting system, JVL Studio has developed various custom made lighting fixtures (adjustable and fixed recessed spotlights) with high quality light sources, all on a dimmable circuit to achieve comfortable light intensity aligned to the client's health condition. These custom design lamps are produced and supplied by JVL Studio.

All the linear lights on coves are replaced with more sophisticated products containing diffusers and with consistent color temperature. Additional lighting is applied where necessary and the whole setting is supported with portable battery operated lamps to serve also for the outdoor areas of the boat where electricity is not available. The lighting control system is replaced by Lutron EcoSystem, which allows for the creation of lighting scenarios according to different times of the day with energy savings.

a tailor made design





*for a client
who has visual problems*

*journey of
Lagoon 630 MY*



existing situation



visual noise

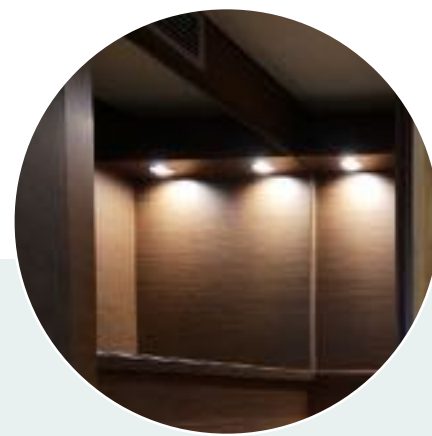
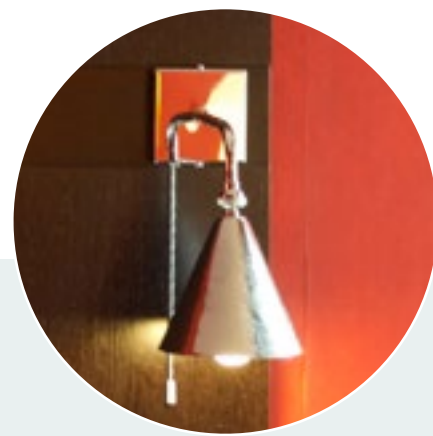

reflection

glare



not user-friendly control

NOSTALJI

JVL STUDIO



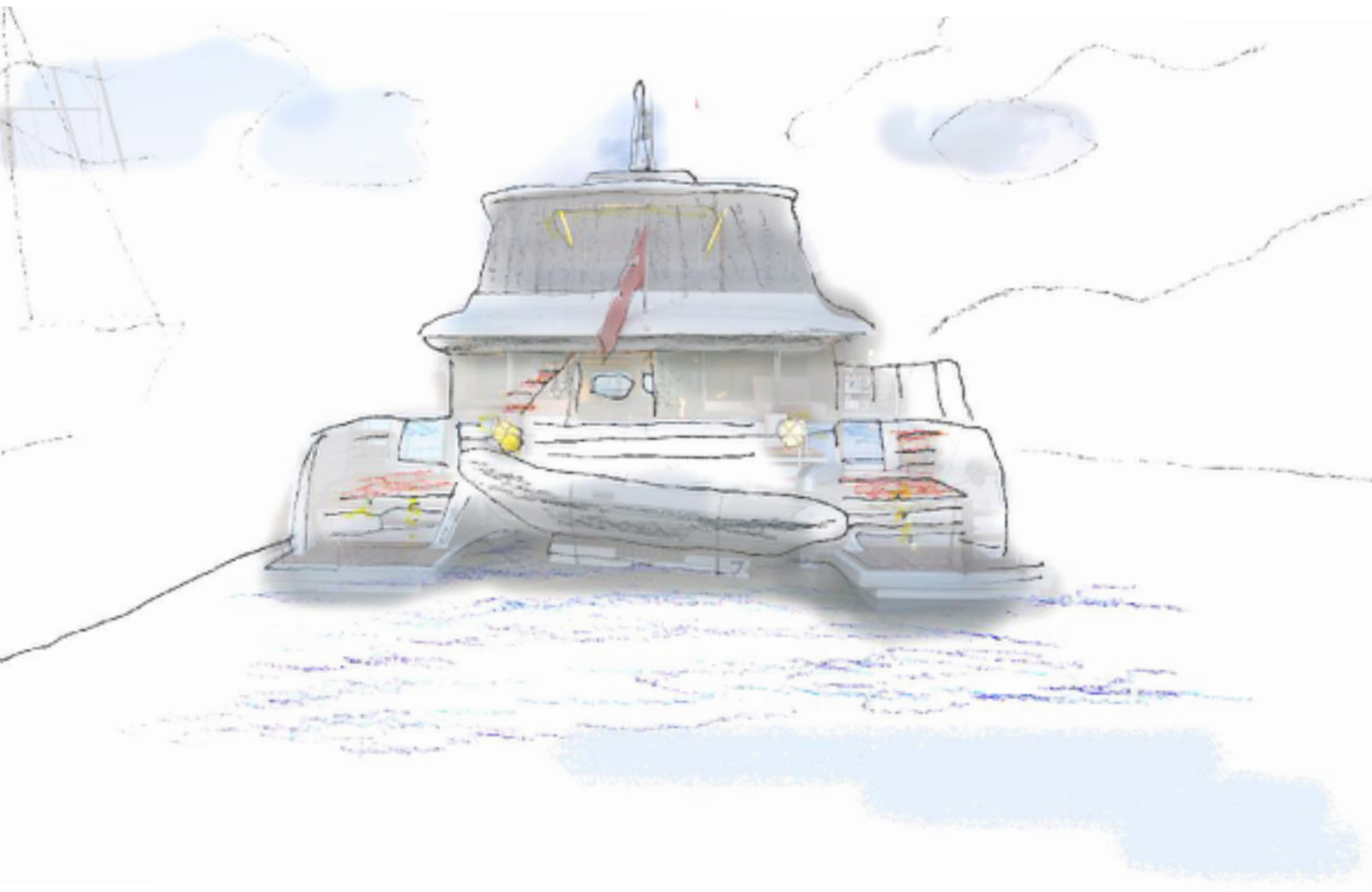

our approach

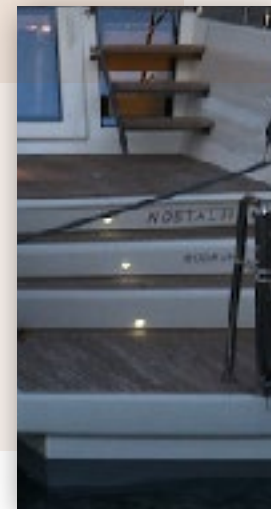
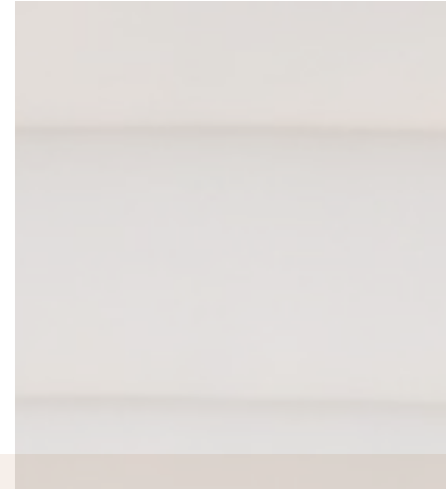



lighting plan



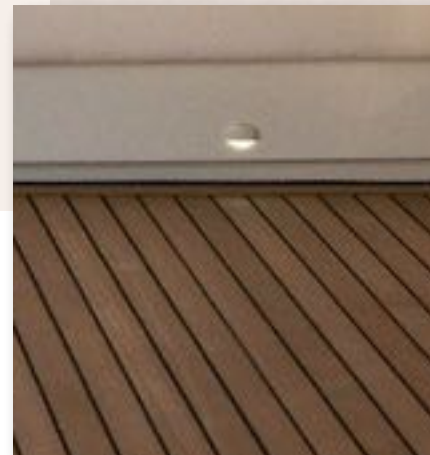
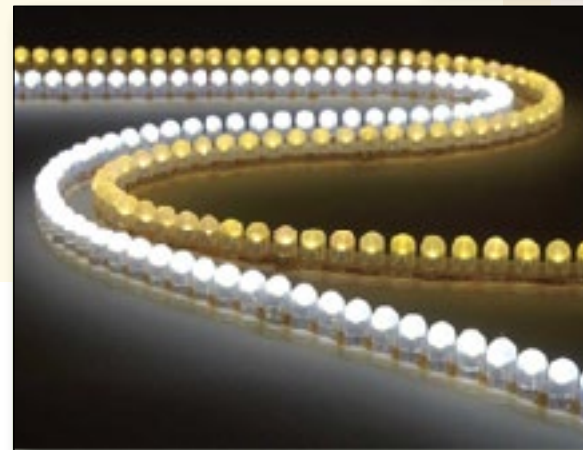





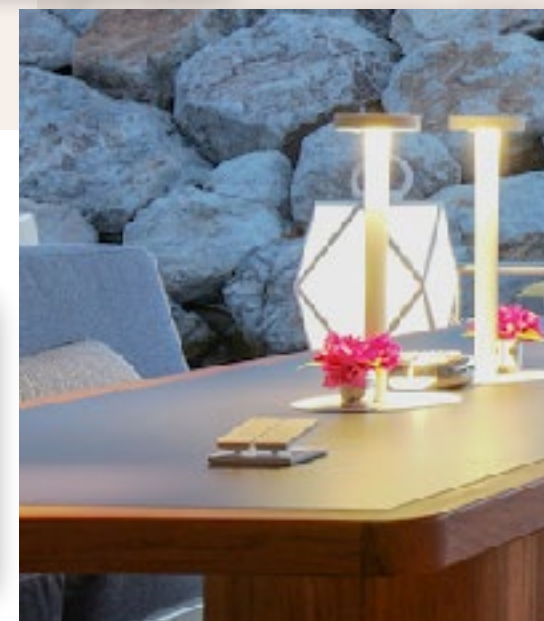



adjustable downlight with IP

Adjustable downlight are added to cockpit outdoor areas.

Anti-glare, dimmable and with good colour temperature as matching with client's expectations.

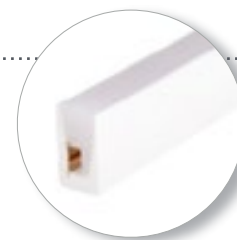

diffused led strip /
led strip sitting in side



mounting profile

cove lighting

Existing led strip replaced with diffused led strip with bendable mounting profile.

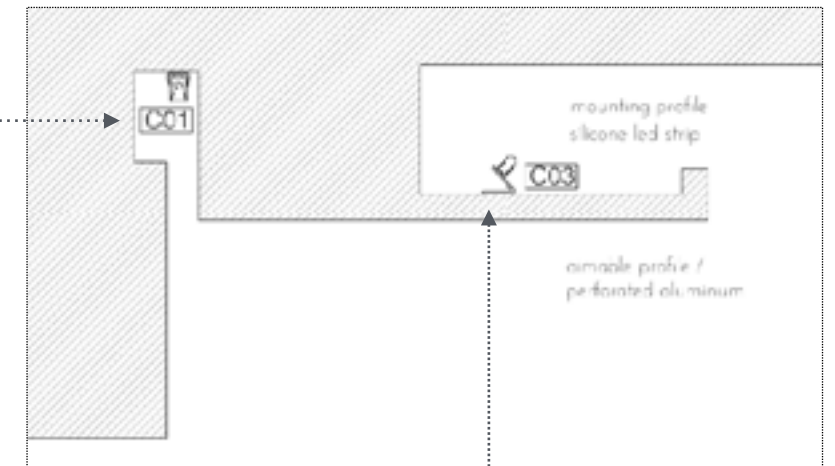

Additional silicone led strip added, giving a general ambience to saloon.

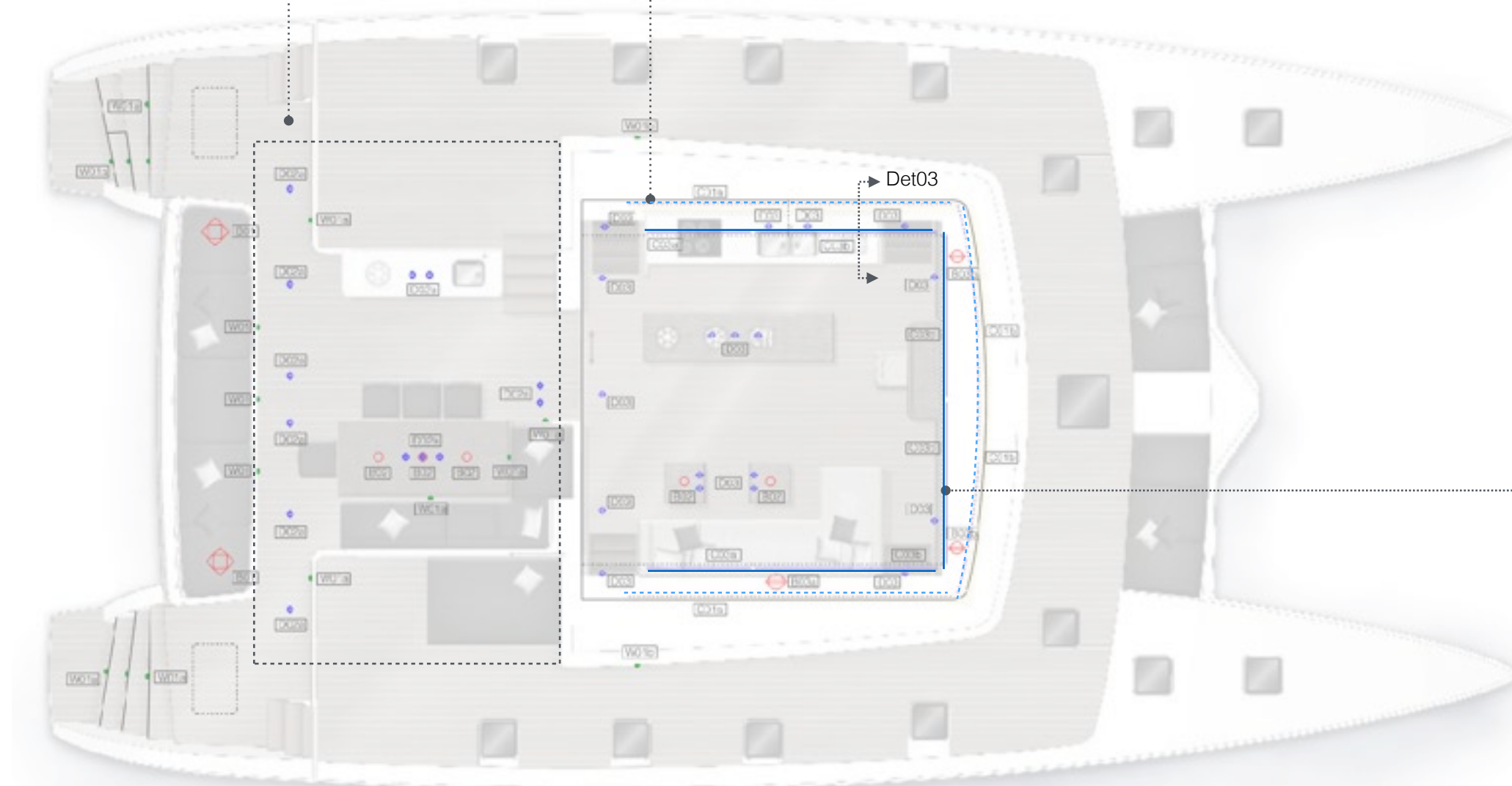
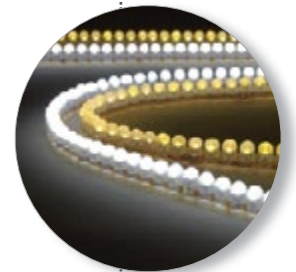

COCKPIT - SALOON

lighting fixtures



adjustable downlight

Anti-glare, adjustable, dimmable and with good colour temperature as matching with client's expectations.

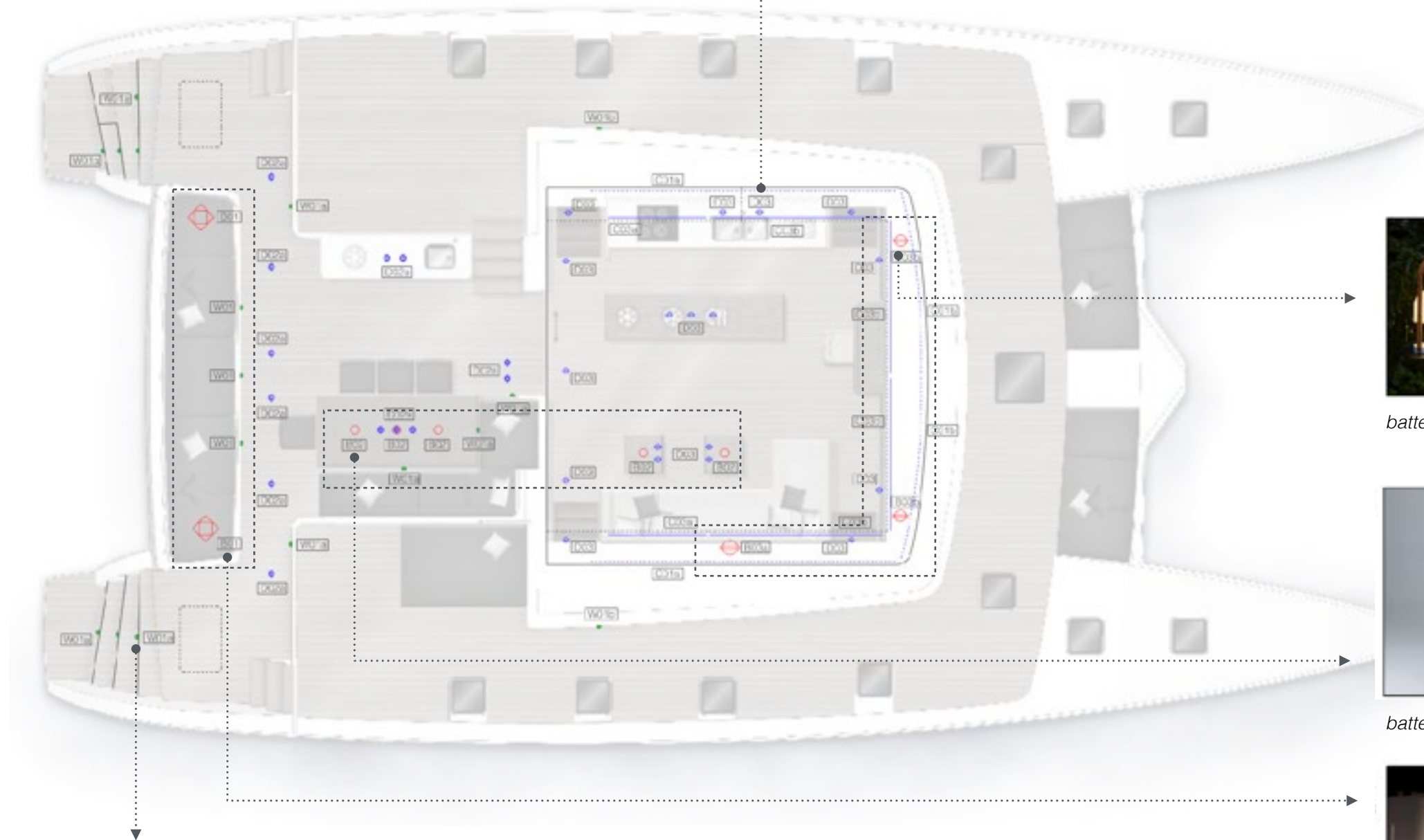

battery operated lights



battery operated lights

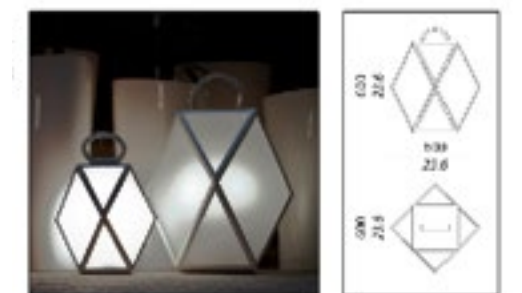

battery operated lights



All W01 courtesy lights replaced with the same fixture but in warm white color.

*All existing fixtures to be demounted by pulling the cap horizontally and unscrew.
Additional lights for upper step access.*

COCKPIT - SALOON

lighting fixtures





adjustable downlight



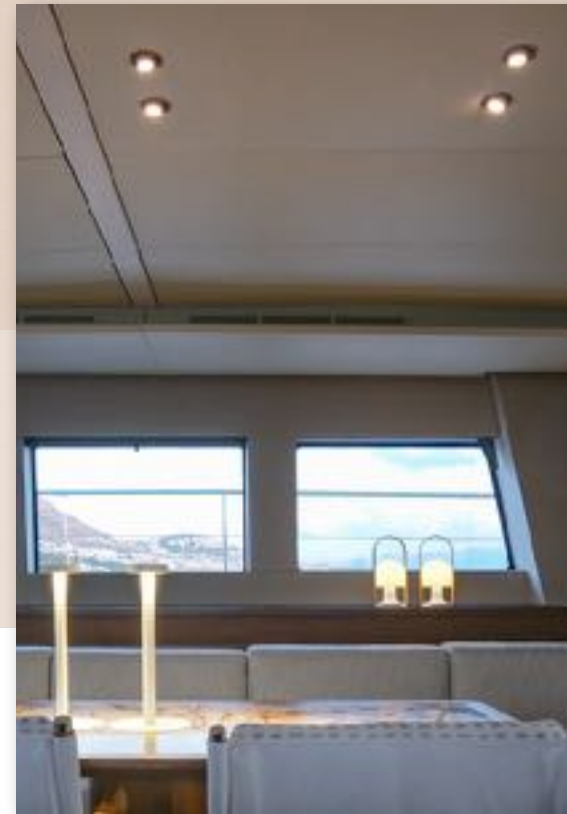
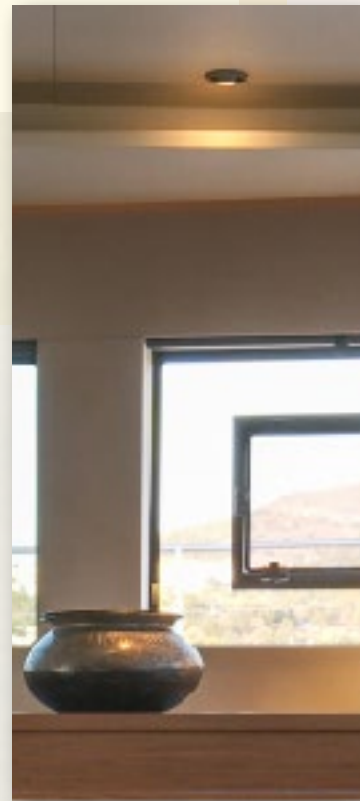
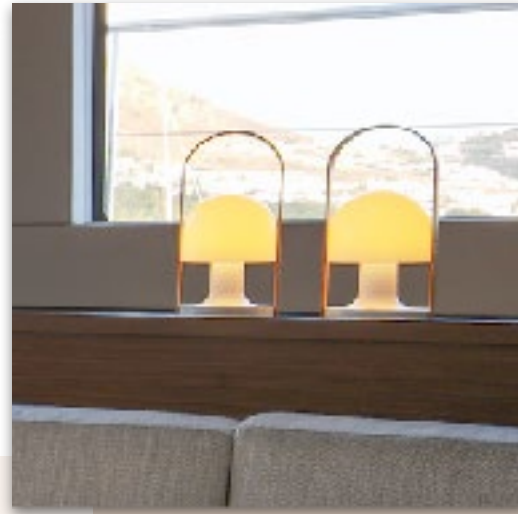



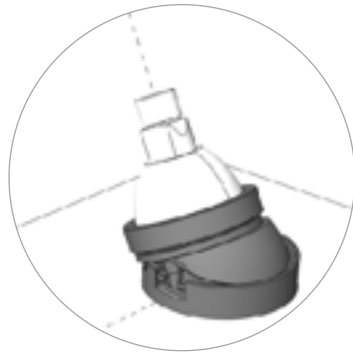

adjustable downlight







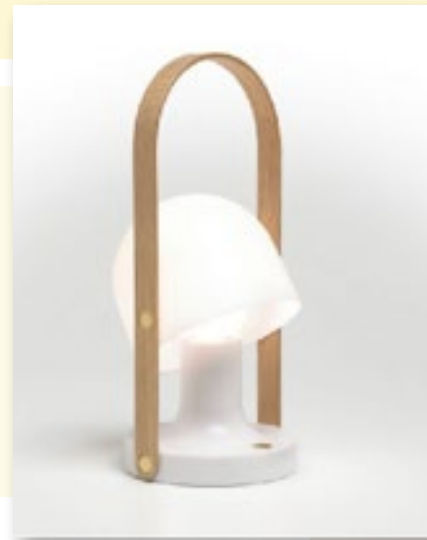
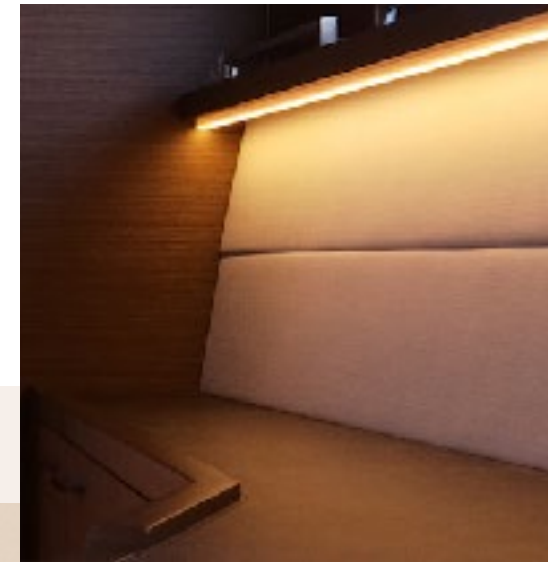



BEDROOMS

lighting plan

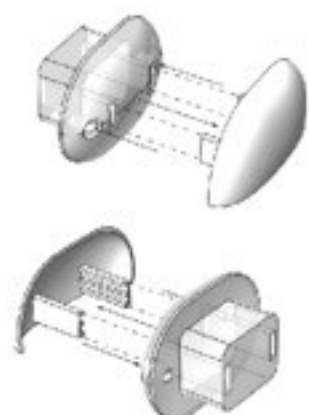

courtesy lights

Existing courtesy lights replaced with warm white light and polished mirror cap.

Additional ones added on upper steps access and cabling from the gap behind removable step.

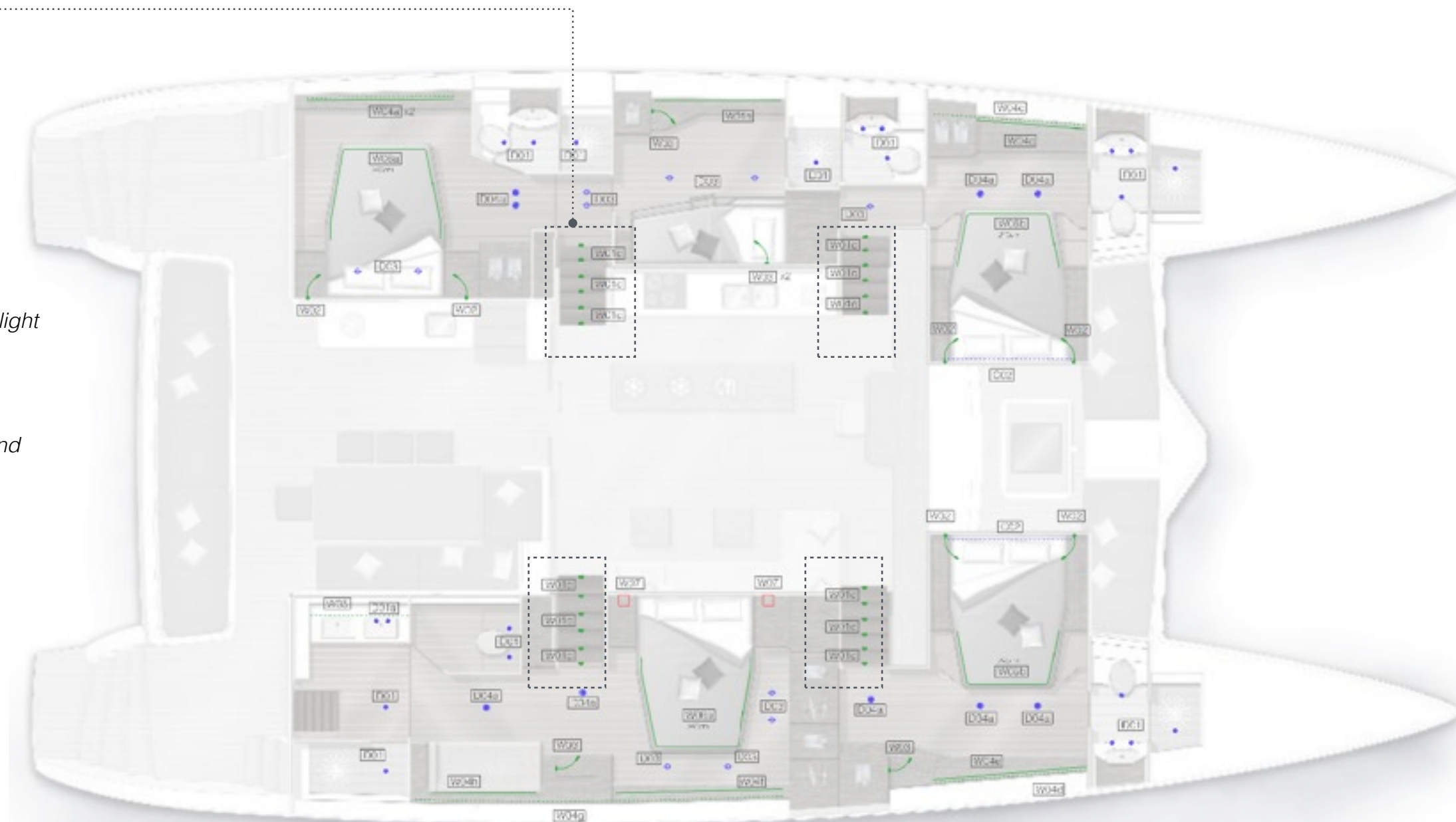

BEDROOMS

lighting fixtures



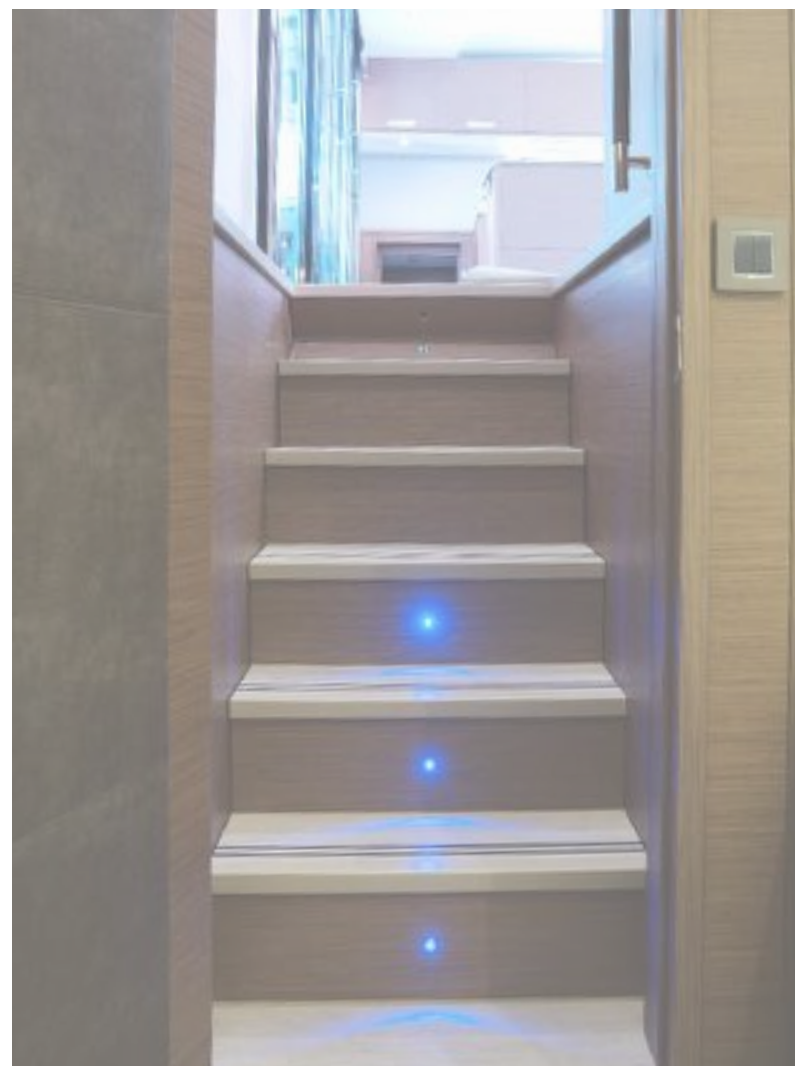

All W04 led strips replaced with diffused led strip.

window desk lighting

Det01

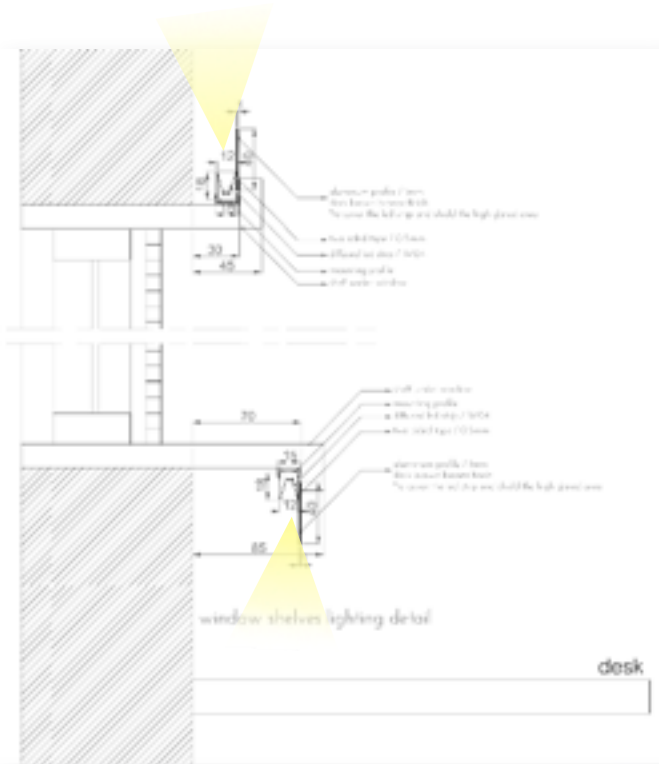

Detail 01



BEDROOMS

lighting fixtures





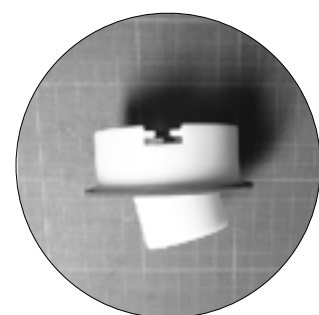

BEDROOMS

lighting fixtures

diffused led strip with mounting profile applied for bed covers.

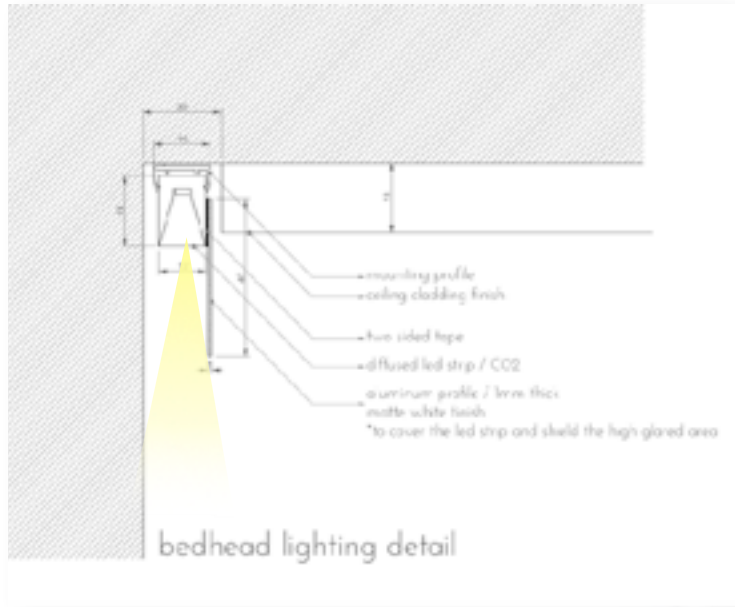

Detail 02: Bed cove lighting

A flat aluminium profile with 40mm height added on led strip in order to hide the sticking out part of the fixture and block the high glazed area on wall surface.

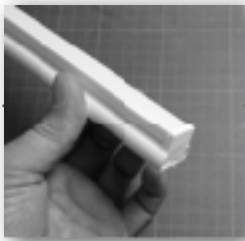

flexible diffused led strips added under bed bases.



diffused led strip / led strip sitting in bottom



diffused led strip / led strip sitting in side









cove lighting



cove lighting



fixed downlight



step lighting

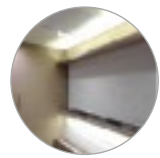

window desk lighting

old lighting fixtures

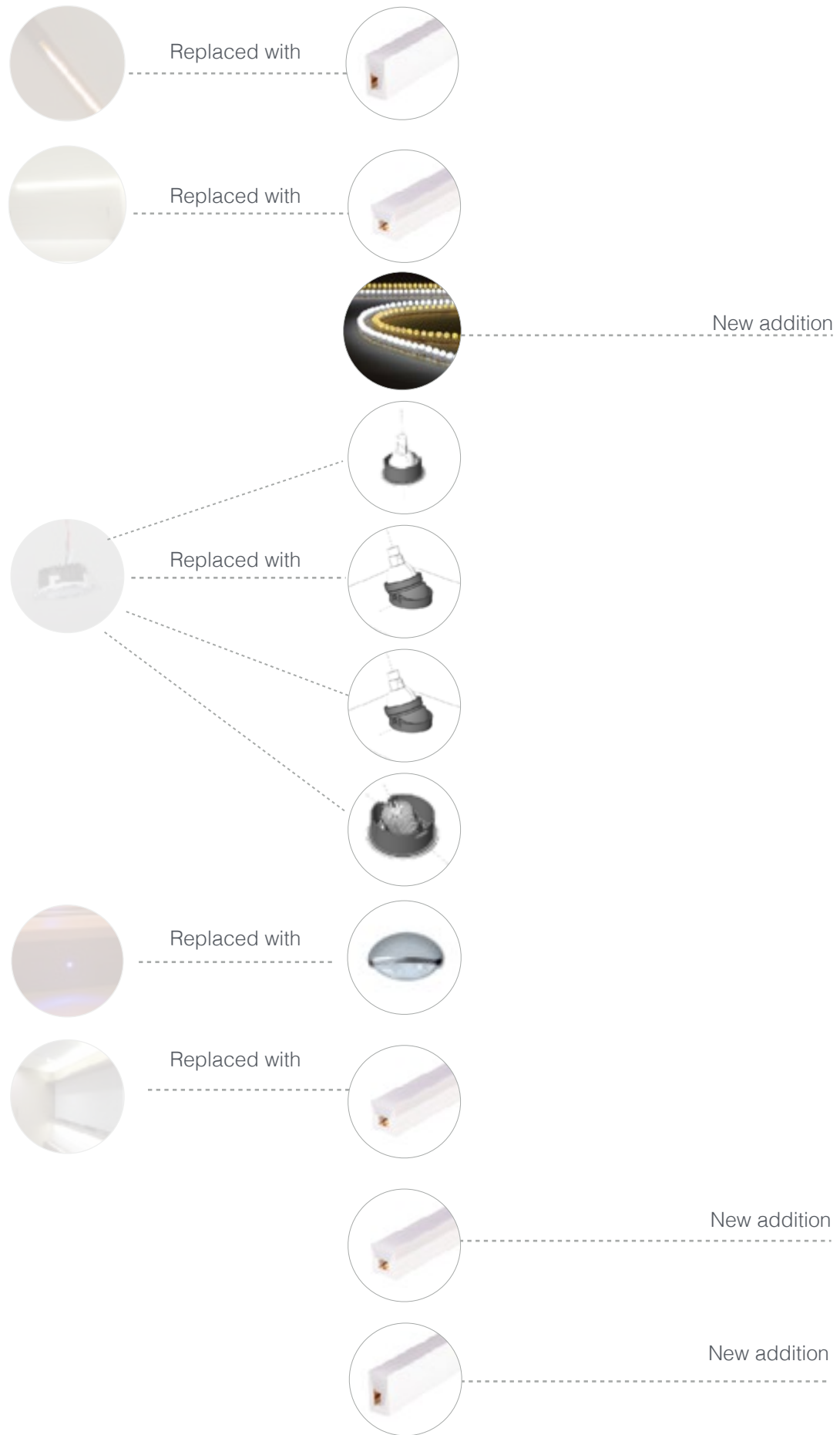

new lighting fixtures



In the previous version there was no lighting scenarios.



With the new automation system, user can have different lighting scenarios and easily control them all.





JVL STUDIO





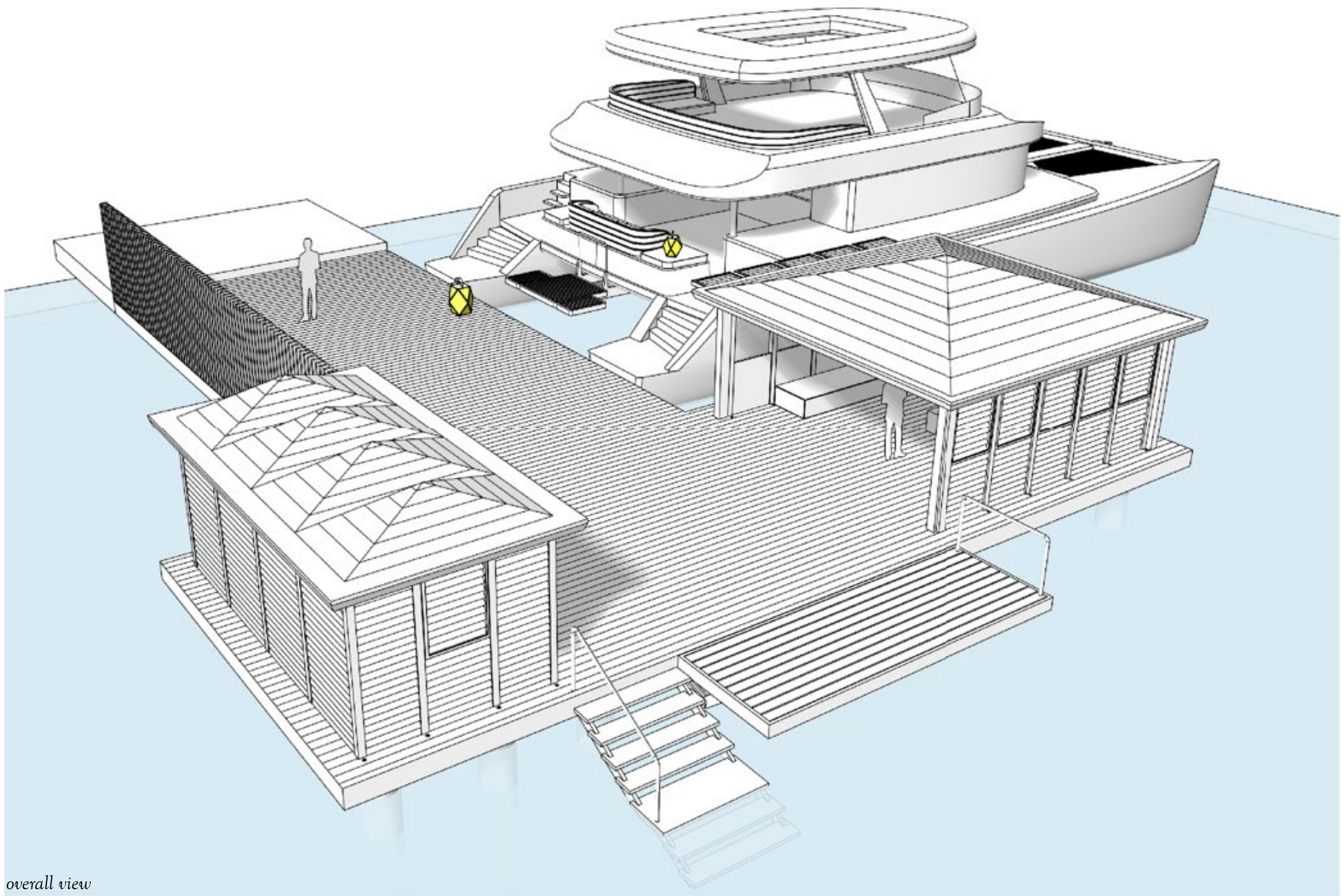

overall view

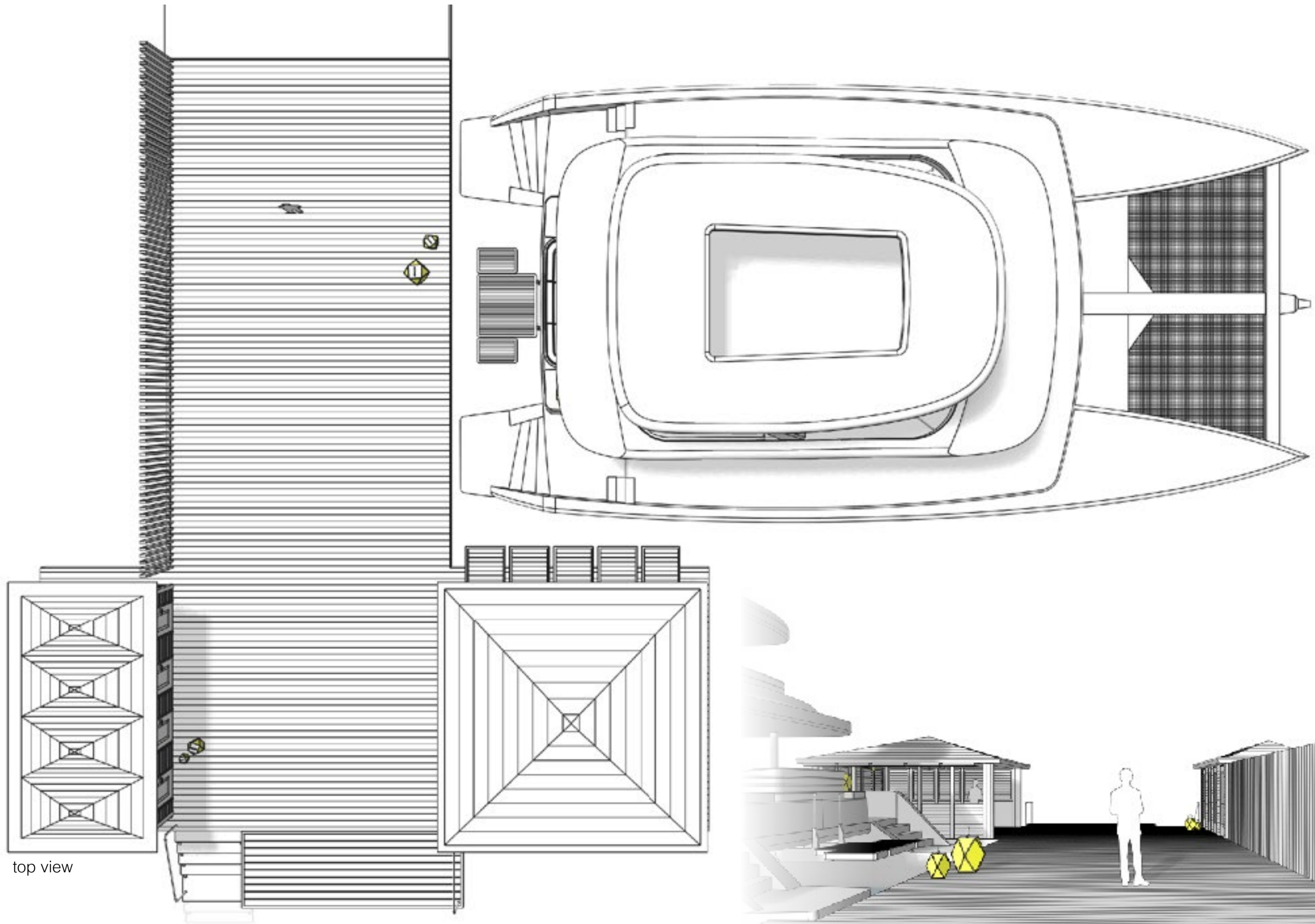

top view

design layout

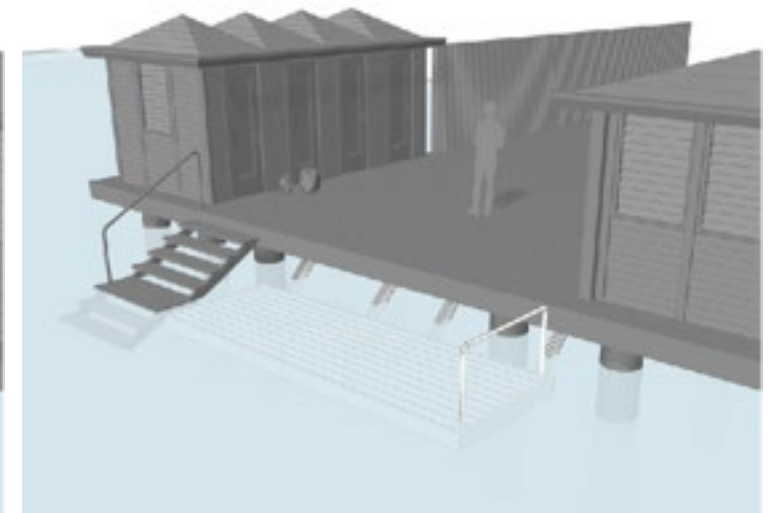
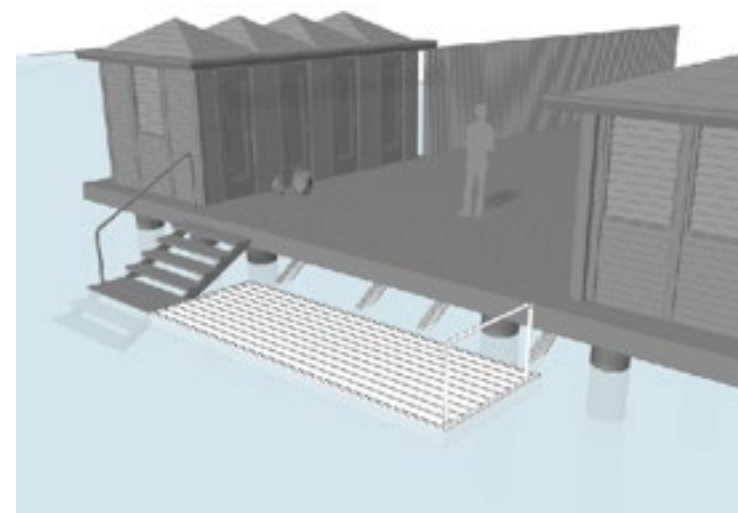
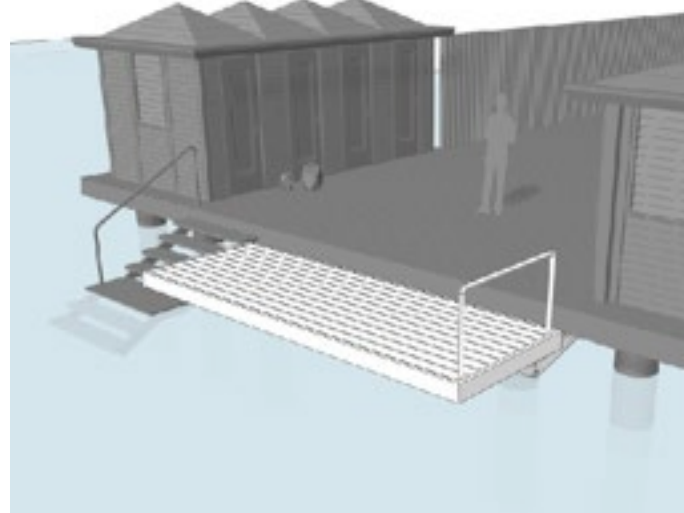
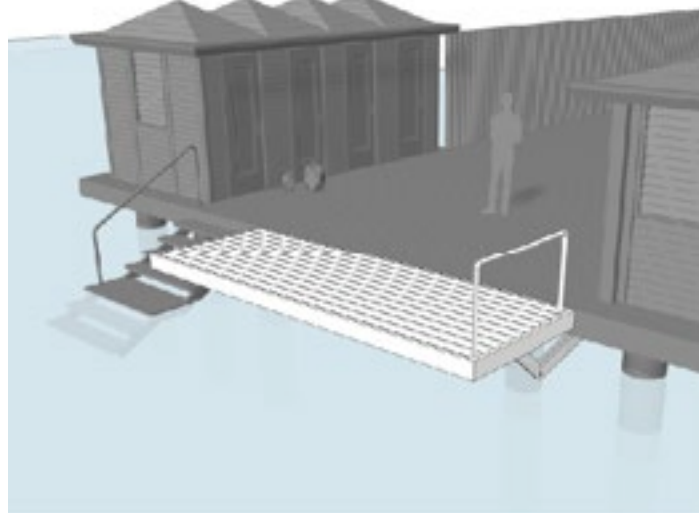
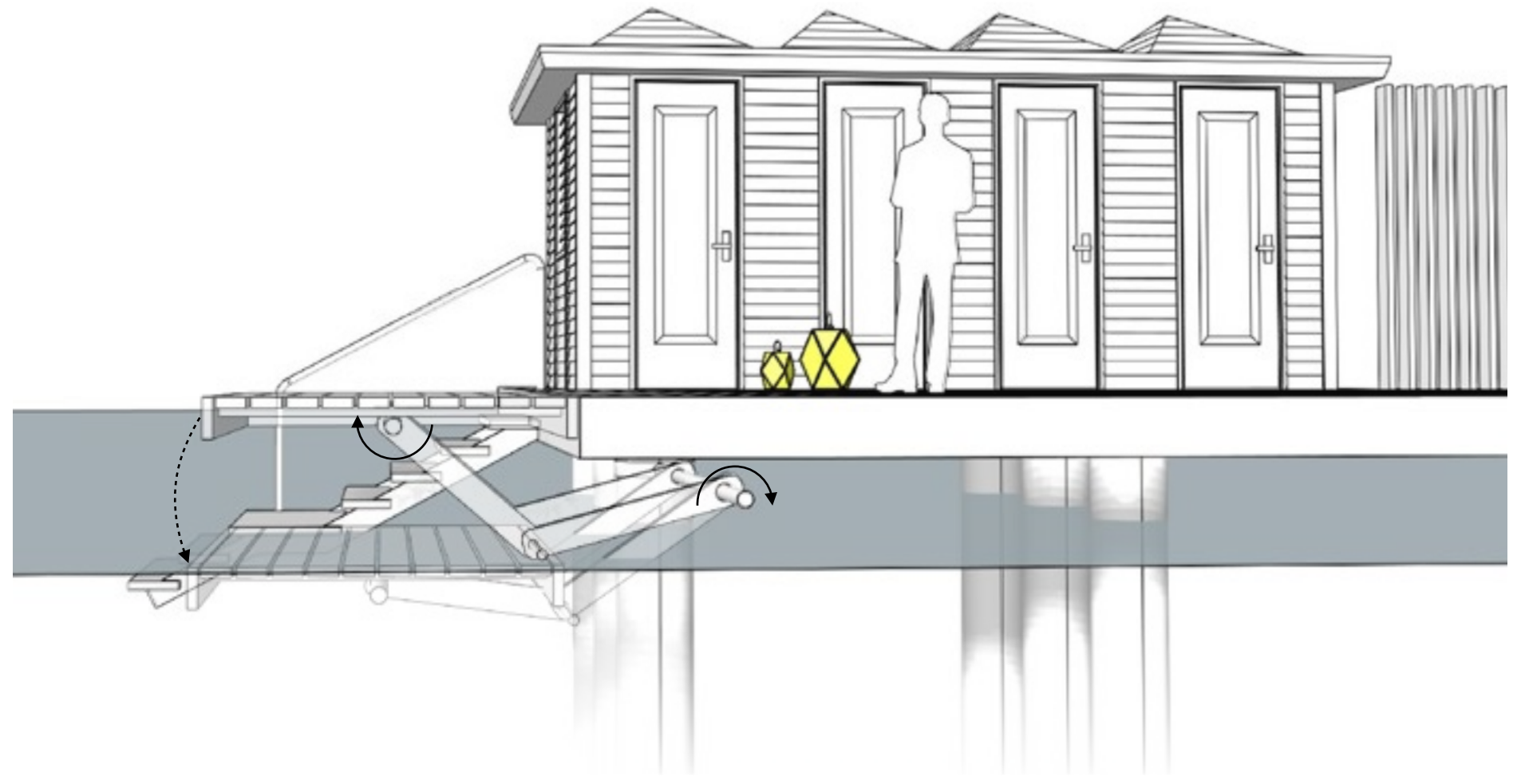
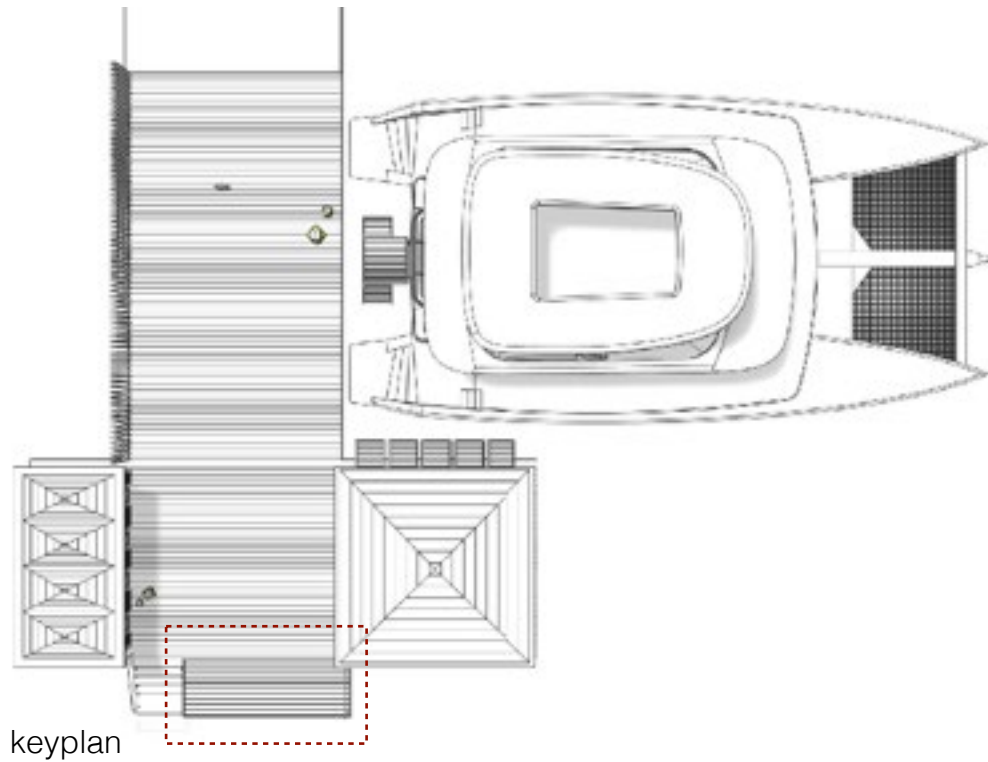

moving sequences

moving platform

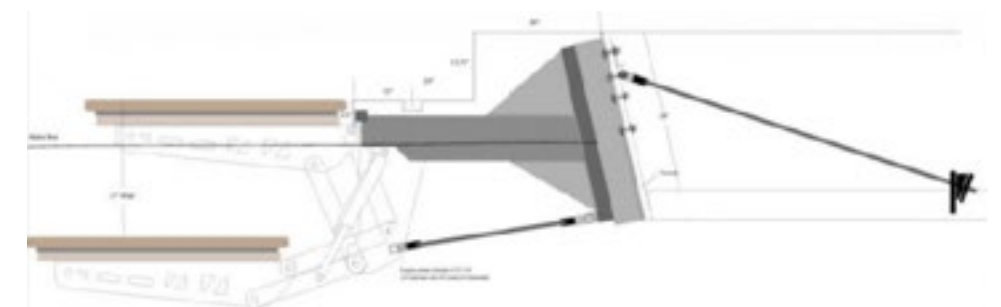



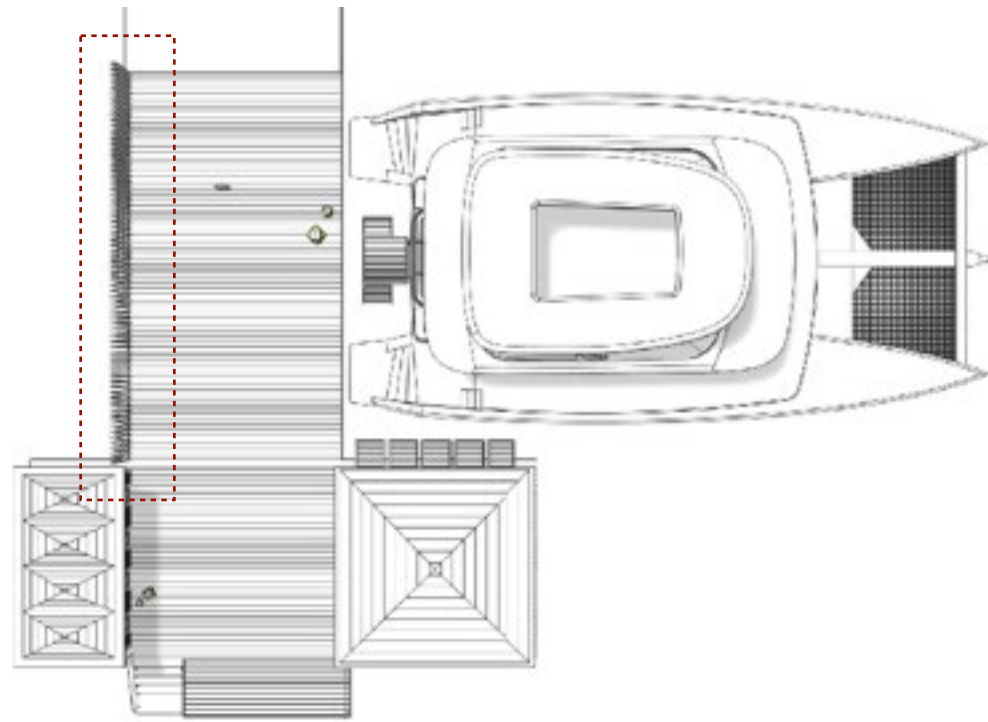

keyplan

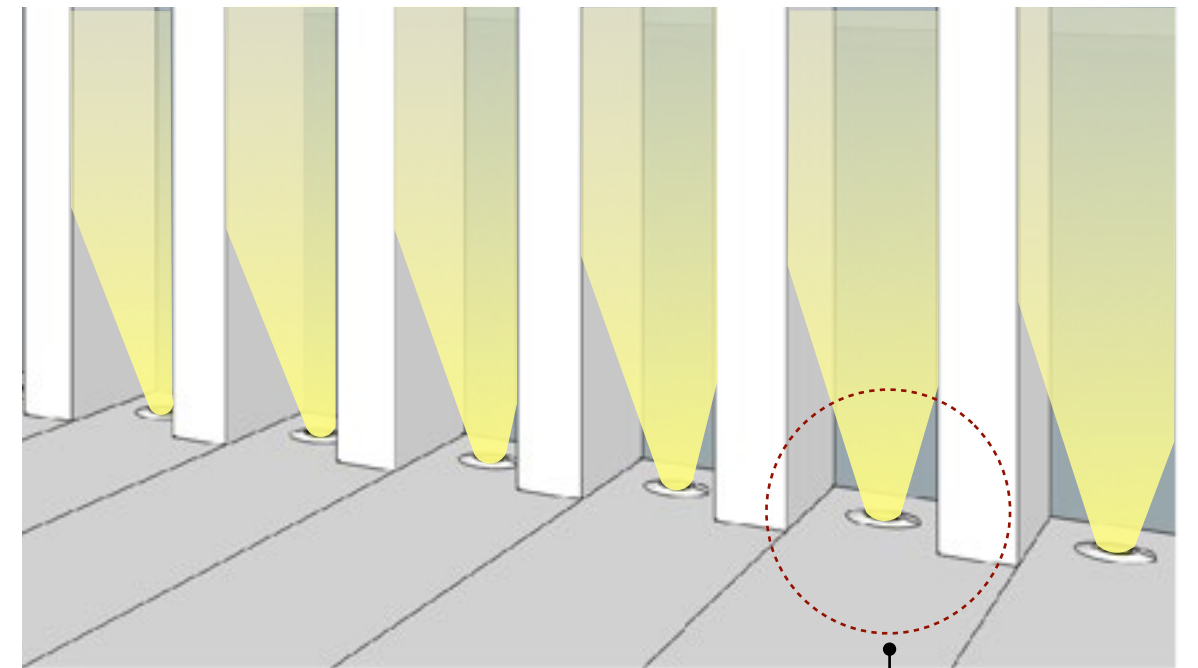

close-up view

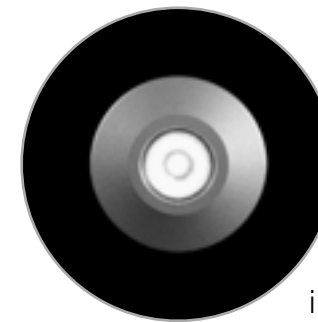

narrow beam
in-ground fixture

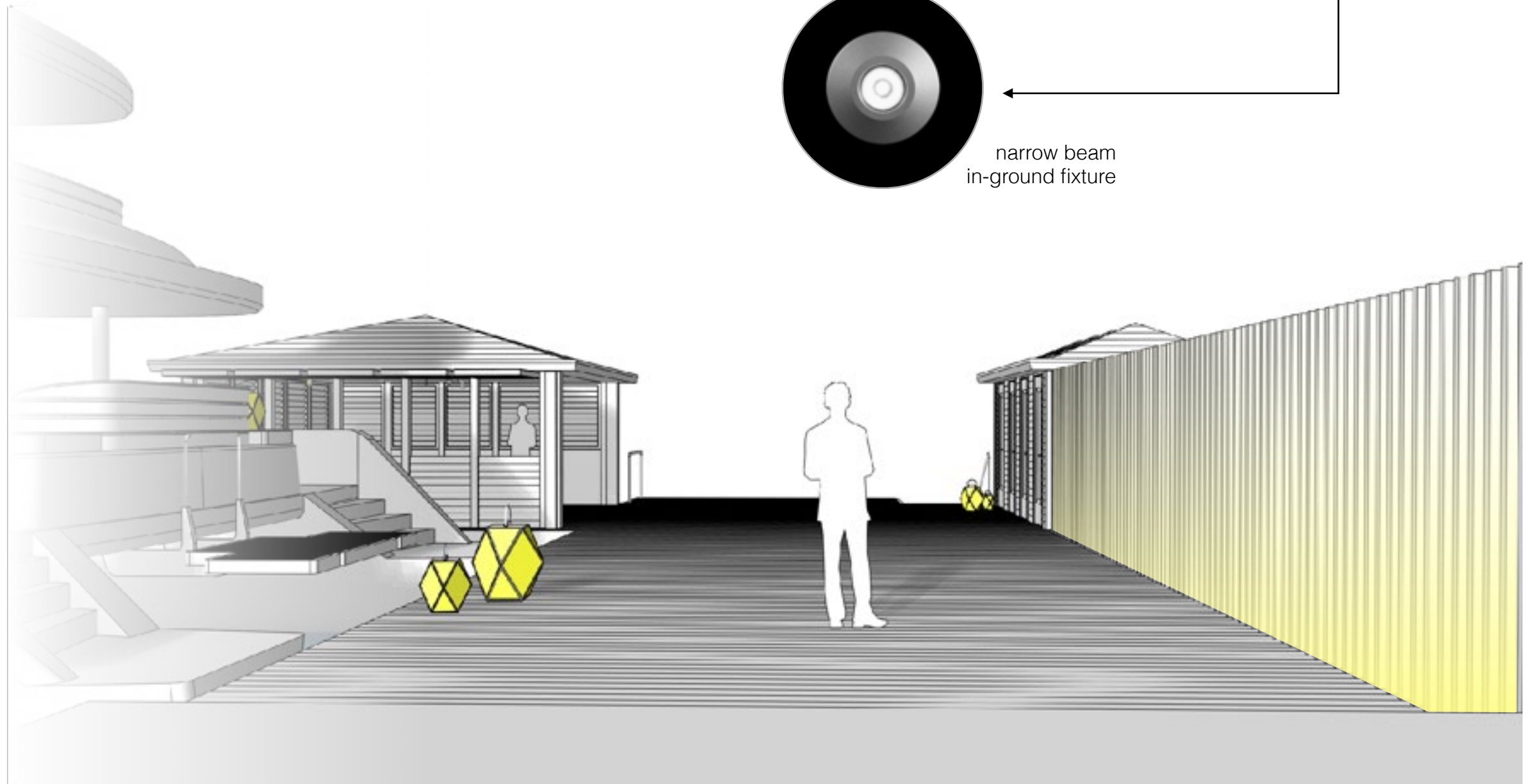

light wall



Private deck

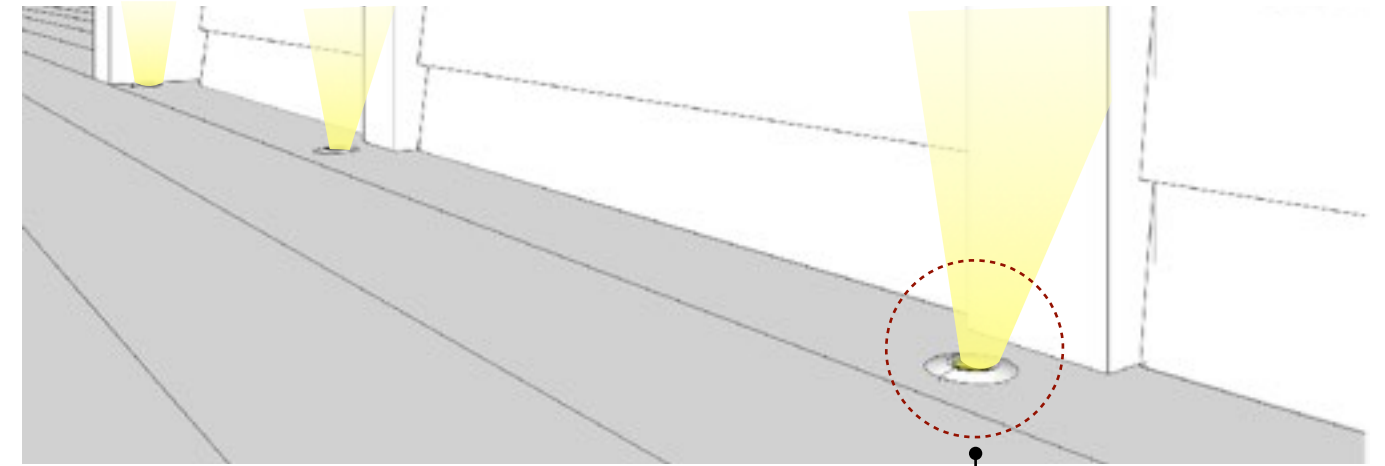
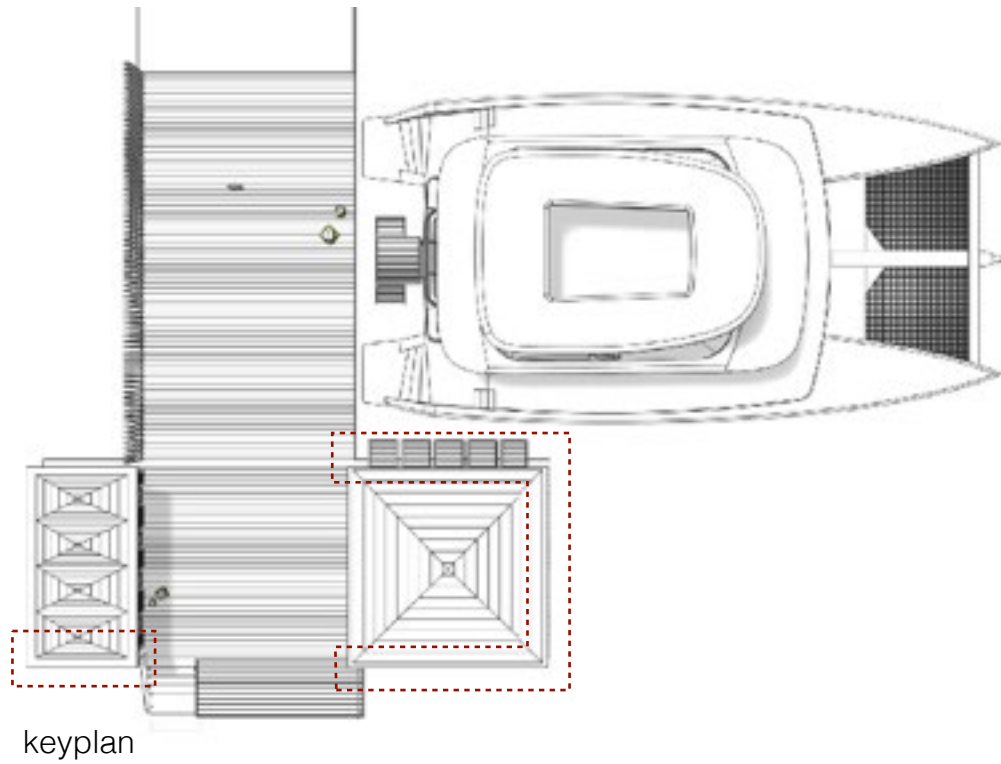

close-up view

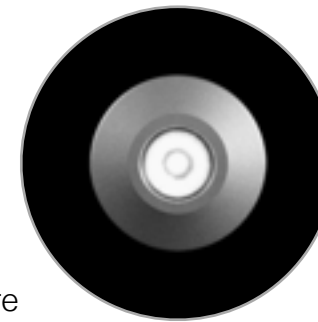

narrow beam
in-ground fixture

